

Commercial Line Low profile evaporator

**Smart
Blue**





INTENSE

Low profile evaporator
For cold rooms up to 4 meters high



1.014 to 13.263 Kcal/h
1.179 to 15.422 W

Standard Version

- Copper tubes of 3/8 "external diameter
- Space between aluminum fins of 4 fpi
- 254mm fan motor
- Tray and cabinet with electrostatic painting white color
- Electric Defrost

Capacity • AC fans

CODE		Kcal/h									Watts								
		Evaporation temperatures									Evaporation temperatures								
		-31 °F -35 °C	-22 °F -30 °C	-13 °F -25 °C	-4 °F -20 °C	5 °F -15 °C	14 °F -10 °C	23 °F -5 °C	32 °F 0 °C	41 °F 5 °C	-31 °F -35 °C	-22 °F -30 °C	-13 °F -25 °C	-4 °F -20 °C	5 °F -15 °C	14 °F -10 °C	23 °F -5 °C	32 °F 0 °C	41 °F 5 °C
SDE05420	N G	1014	1046	1077	1120	1151	1173	1225	1310	1373	1179	1216	1253	1302	1339	1363	1425	1523	1597
SDE06620	N G	1205	1262	1303	1344	1385	1410	1476	1574	1656	1401	1468	1516	1563	1611	1640	1716	1830	1926
SDE09220	N G	1694	1766	1827	1898	1939	1980	2082	2215	2327	1970	2053	2124	2207	2255	2302	2421	2575	2706
SDE11320	N G	2071	2151	2221	2308	2373	2413	2533	2692	2842	2409	2501	2582	2683	2759	2806	2945	3130	3304
SDE15020	N G	2753	2853	2944	3044	3125	3195	3356	3567	3778	3201	3318	3423	3540	3633	3715	3902	4147	4393
SDE16820	N G	3101	3215	3321	3429	3528	3616	3783	4029	4245	3606	3738	3862	3988	4102	4205	4399	4685	4936
SDE19620	N G	3604	3746	3867	3988	4099	4190	4392	4685	4937	4191	4356	4496	4637	4766	4872	5107	5447	5741
SDE21720	N G	3998	4145	4283	4420	4537	4645	4871	5174	5468	4649	4820	4980	5139	5276	5401	5664	6017	6359
SDE25220	N G	4474	4634	4795	4945	5076	5196	5577	6009	6340	5202	5389	5575	5750	5902	6042	6485	6987	7372
SDE31920	N G	5667	5878	6080	6271	6432	6583	7066	7612	8032	6589	6835	7069	7292	7479	7654	8216	8851	9340
SDE37320	N G	6621	6865	7089	7323	7507	7690	8254	8892	9402	7698	7983	8243	8515	8729	8942	9598	10340	10932
SDE42220	N G	7490	7769	8038	8287	8499	8710	9349	10072	10634	8710	9034	9346	9637	9882	10128	10871	11712	12365
SDE52620	N G	9337	9698	10030	10351	10612	10873	11671	12573	13263	10857	11277	11662	12036	12339	12643	13570	14620	15422

Capabilities (DT=10,8°F / DT1=6 K)

(*) The same capacities for 50Hz and 60 Hz / R404A, R507A, R407A, R407C and R-22. Other refrigerant gases, NH₃ or CO₂, contact us.

Air reach

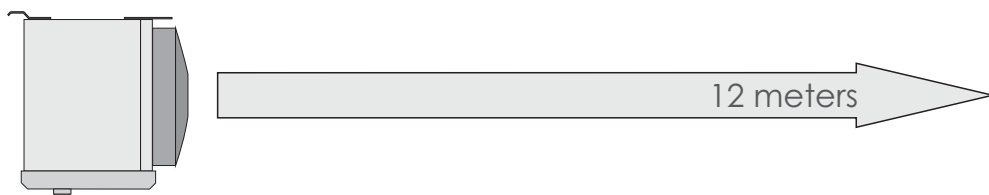

Dimensions

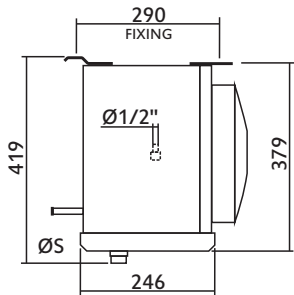
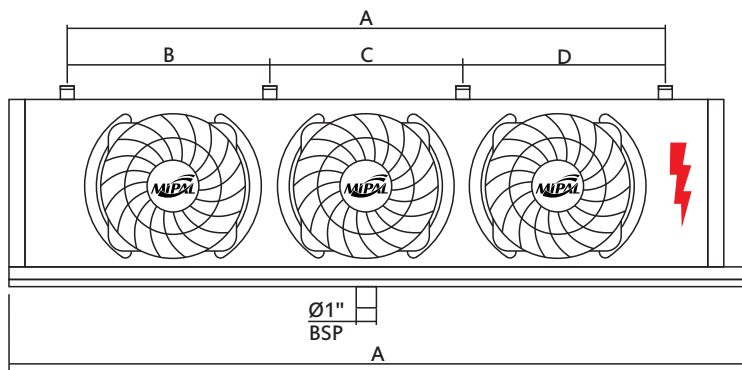

CODE N = 60Hz G = 50Hz		A	B	C	D	ØS	
SDE05420	N G	1	663	399	-	-	1/2"
SDE06620	N G	2	1022	762	-	-	1/2"
SDE09220	N G	2	1022	762	-	-	5/8"
SDE11320	N G	2	1022	762	-	-	7/8"
SDE15020	N G	3	1385	1125	-	-	7/8"
SDE16820	N G	3	1385	1125	-	-	7/8"
SDE19620	N G	4	1747	762	-	726	1 1/8"
SDE21720	N G	4	1747	762	-	726	1 1/8"
SDE25220	N G	5	2111	762	363	726	1 1/8"
SDE31920	N G	6	2474	762	726	726	1 1/8"
SDE37320	N G	6	2474	762	726	726	1 1/8"
SDE42220	N G	7	2841	762	1089	726	1 1/8"
SDE52620	N G	9	3563	1125	1089	1089	1 1/8"

Specifications

CODE N = 60Hz G = 50Hz	C	N	Fans			Electric Defrost		
			Refr. Kg	dB (A) (1m)	m ³ / h	230V 1Ø W	230V 1Ø A	W
SDE05420	N G	0,90	51	1000	73	0,6	2 x 500	4,6
SDE06620	N G	0,90	53,6	2000	146	1,2	2 x 1000	9,1
SDE09220	N G	1,08	53,8	2000	146	1,2	2 x 1000	9,1
SDE11320	N G	1,79	54	2000	146	1,2	2 x 1000	9,1
SDE15020	N G	2,02	55,6	3000	219	1,8	2 x 1500	13,6
SDE16820	N G	2,69	55,8	3000	219	1,8	2 x 1500	13,6

CODE N = 60Hz G = 50Hz	C	N	Fans			Electric Defrost		
			Refr. Kg	dB (A) (1m)	m ³ / h	230V 1Ø W	230V 1Ø A	W
SDE19620	N G	2,69	56	4000	292	1,8	2 x 2000	18,1
SDE21720	N G	3,58	56,8	4000	292	2,4	2 x 2000	18,1
SDE25220	N G	3,36	57	5000	365	2,4	2 x 2500	22,7
SDE31920	N G	4,30	58	6000	438	3,0	2 x 3000	27,2
SDE37320	N G	5,38	59	6000	438	3,6	2 x 3000	27,2
SDE42220	N G	6,27	60	7000	511	4,2	2 x 3500	31,8
SDE52620	N G	6,45	61	9000	657	4,8	2 x 4500	41,0

C • Kg • Approximate charge of refrigerant gas.
m³/h • Air flow measured the density of 1.2m³ / Kg.

N • dB(A) • Noise level obtained in open field conditions at a distance of 1 meter. The actual noise level depends on factors such as camera construction, type of load and number of installed devices.

How to buy

S	D	E	054	2	0	N
S - Smart Blue AC	Application Low temperature D - 4APP (6mm)	Defrost E • Electrical	Model 054 to 622	Finishing 2 • White Cabinet	Accessories 0 • Standard with AC motor (direct expansion)	Electrical N • 230V/1F/60Hz G • 230V/1F/50Hz

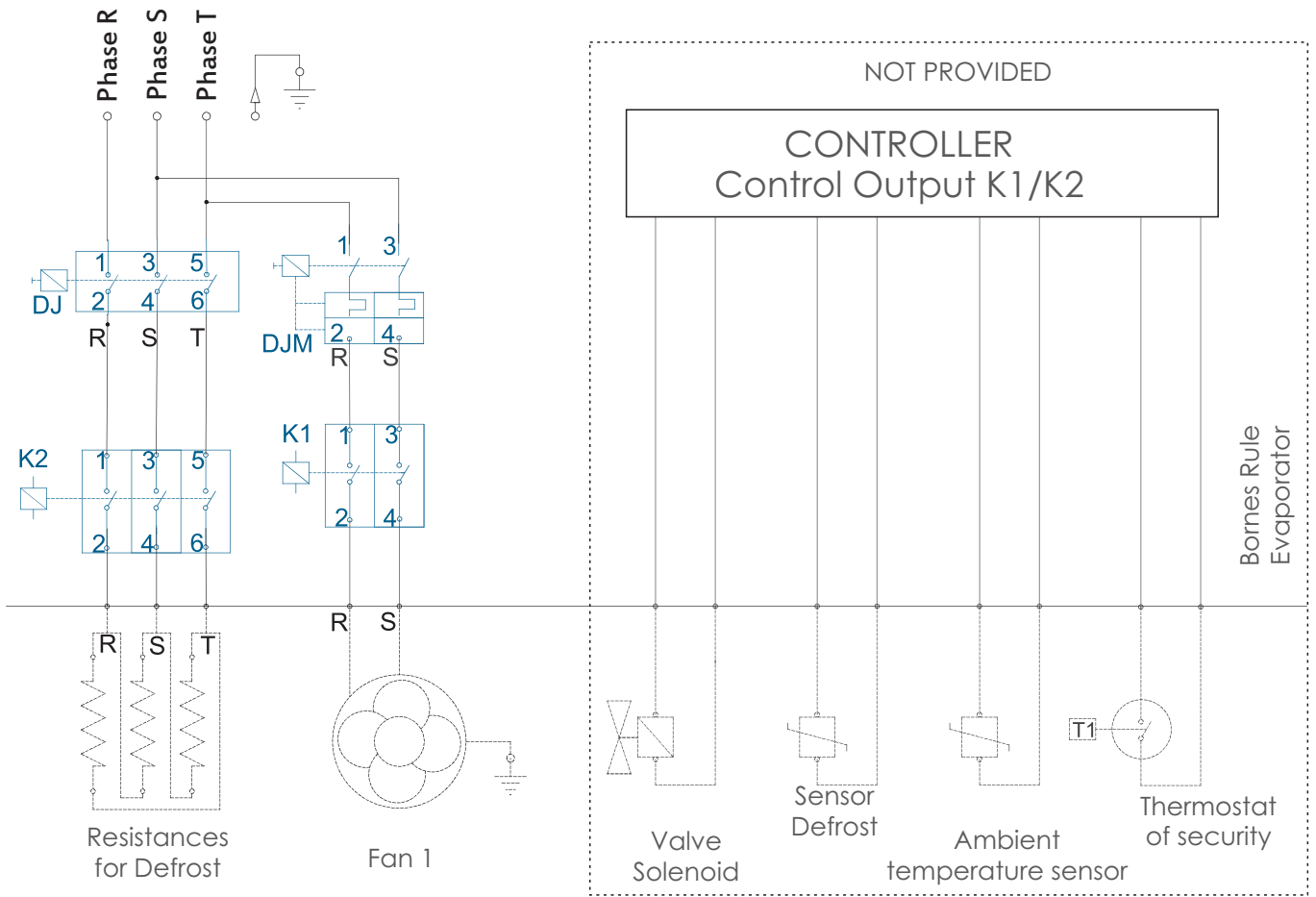

Subtitles:
 K1 = Contact of the fans
 K2 = Contact of Resistances
 DJ = Circuit Breaker
 DJM = Motor circuit breaker

- Attention:
- To dimension the components of the installation, consult the catalog data tables.
 - To change the factory supply, contact our engineering.
 - Safety probe preventing high temperature. Install in the adjusted electrical panel MAX40°C
 - Always use the ground wire.

Defrost Sensor

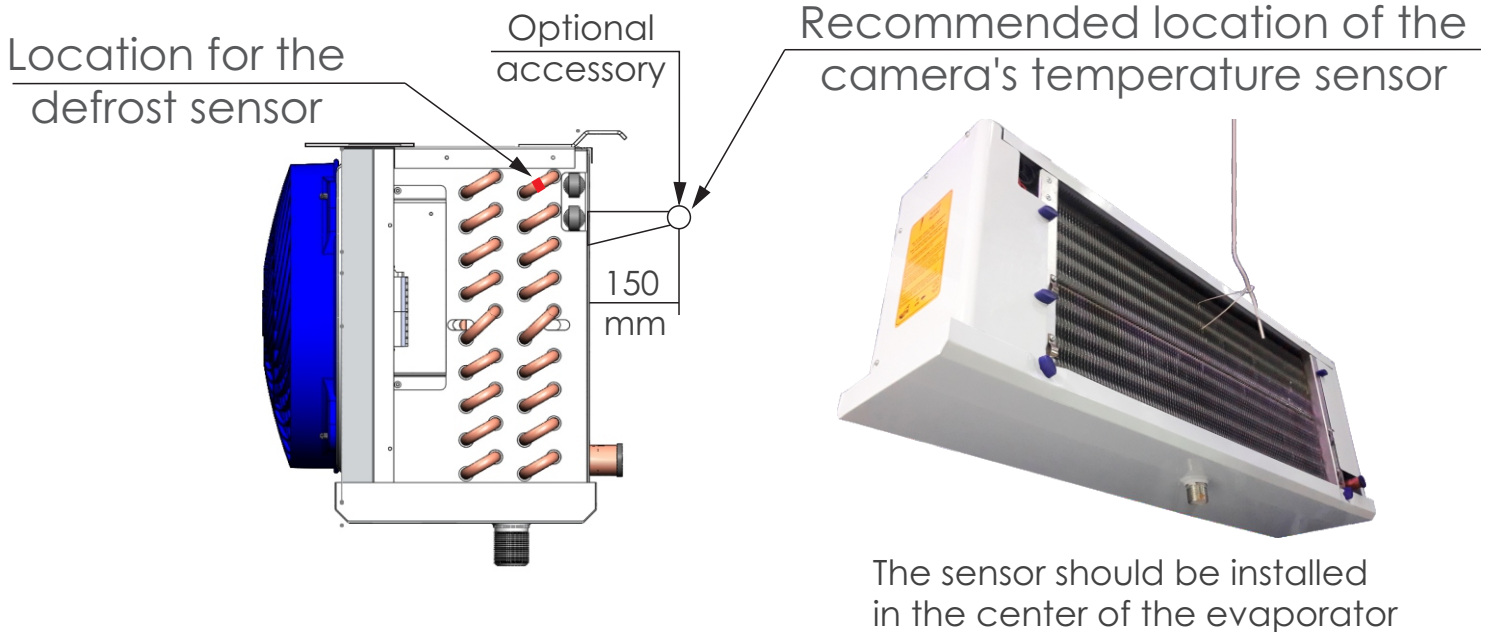

Mipal reserves the right to change the data presented in this catalog without previous notice, for an updated version see our website www.mipal.com.br
 The photos presented in this catalog are merely illustrative.